

CCF-C SERIES

CCF-C-420

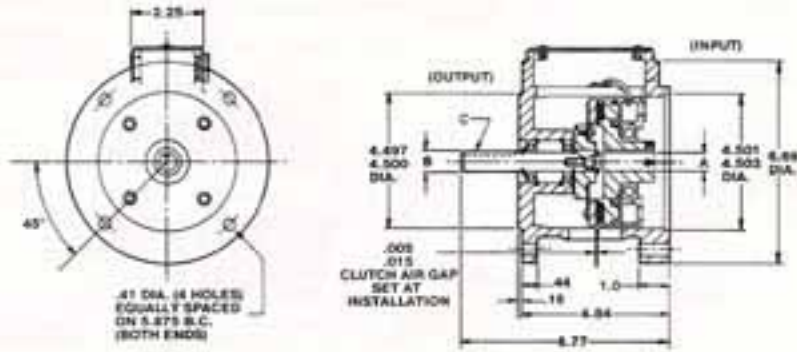

CCF-C-560

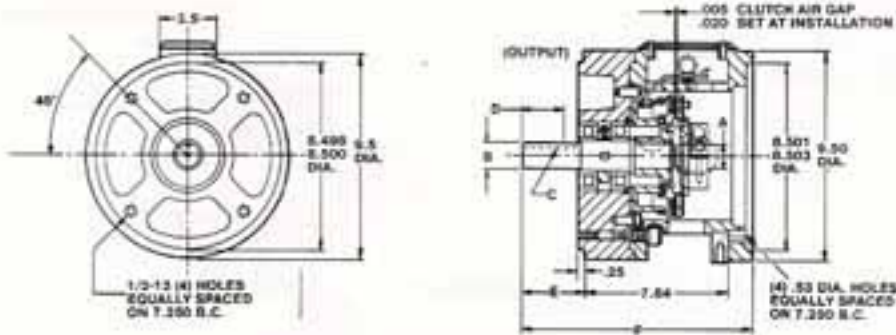

MODEL NO.	A	B	C	D	E	F
CCF-C-420-10	.625 .626	.624 .625	1/16 x 3/32	—	—	—
CCF-C-420-14	.875 .876	.874 .875	1/16 x 3/32	—	—	—
CCF-C-560-18	1.125 1.126	1.274 1.275	1/4 x 1/8	2.0	2.75	10.39
CCF-C-560-22	1.375 1.376	1.374 1.375	1/16 x 3/32	2.75	3.50	11.14

CCF-C-420-560 NOTES:

Models CCF-C can be provided mounted to your motor, as a tested assembled package upon request.

Static torque rating and dynamic torque rating will improve with cycling, which allows the meshing parts to wear-in for maximum torque (and horsepower) transmittal.

TECHNICAL DATA

MODEL NO.	NEMA MOTOR FRAME	RATED STATIC TORQUE (IN.-LBS.)	WEIGHT (LBS.)	MAXIMUM RATED SPEED (RPM)	ELECTRICAL		
					COIL NO.	RATED VOLTAGE (VDC)	CURRENT (AMPS)
CCF-C-420-10	56C	240	12	3600	1	90	.14
					2	28	.54
CCF-C-420-14	143C or 145TC	240	12	3600	3	12	.93
					4	6	1.82
CCF-C-560-18	213C, 215C 182TC, 184TC	600	38	3600	1	90	.37
					2	28	1.13
CCF-C-560-22	254UC, 256UC 213TC, 215TC	600	38	3600	3	12	2.73
					4	6	6.00

CCF-B SERIES

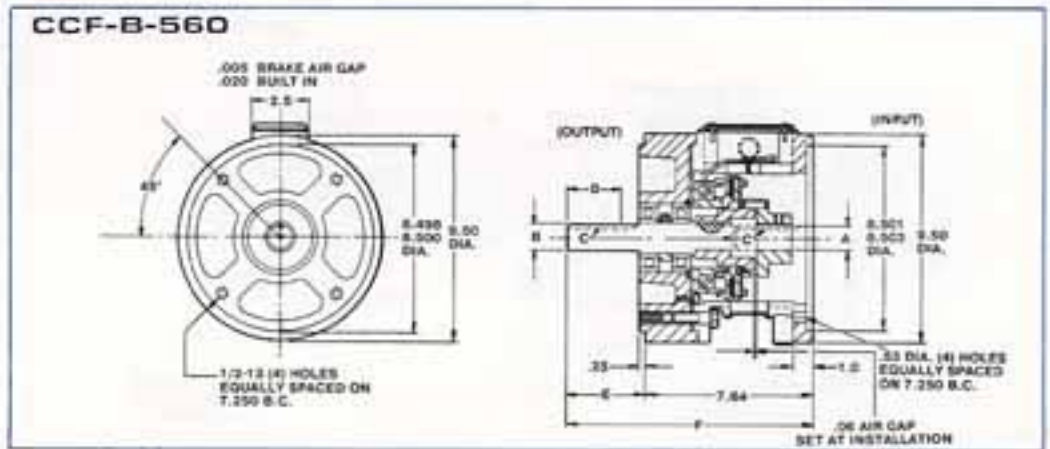
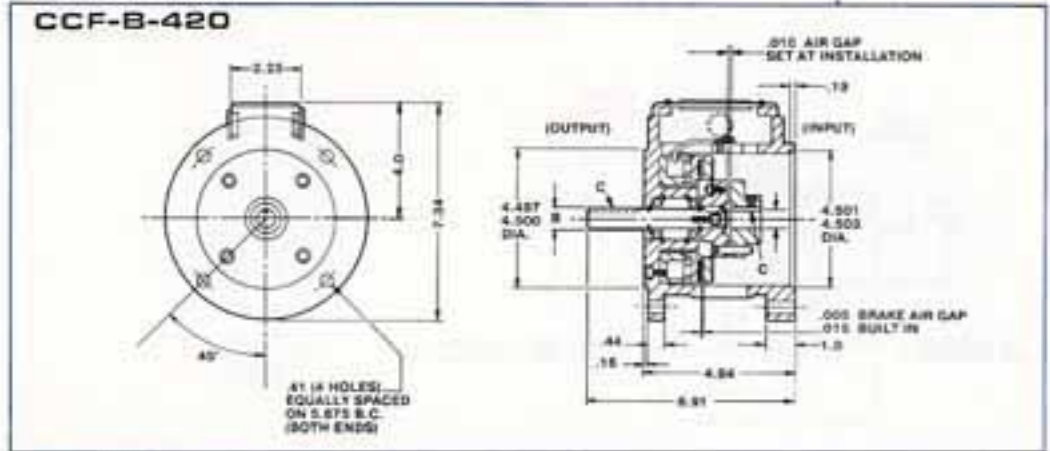

MODEL NO.	A	B	C	D	E	F
CCF-B-420-10	.625 .626	.624 .625	3/16 X 1/32	—	—	—
CCF-B-420-14	.875 .876	.874 .875	3/16 X 1/32	—	—	—
CCF-B-560-18	1.125 1.126	1.124 1.125	1/4 X 1/8	2.0	2.75	10.39
CCF-B-560-22	1.375 1.376	1.374 1.375	3/16 X 1/32	2.75	3.50	11.14

CCF-B-420-560 NOTES:

Models CCF-B can be provided mounted to your motor, as a tested assembled package upon request.
 Static torque rating and dynamic torque rating will improve with cycling, which allows the meshing parts to wear-in for maximum torque (and horsepower) transmittal.

TECHNICAL DATA

MODEL NO.	NEMA MOTOR FRAME	RATED STATIC TORQUE (IN.-LBS.)	WEIGHT (LBS.)	MAXIMUM RATED SPEED	ELECTRICAL		
					COIL NO.	RATED VOLTAGE (VDC)	CURRENT (AMPS)
CCF-B-420-10 CCF-B-420-14	56C, 143C or 145TC	240	12	3600	1	90	.14
					2	28	.54
					3	12	.93
					4	6	1.82
CCF-B-560-18 CCF-B-560-22	213C or 215TC 182TC or 184TC 213C or 215TC 254UC or 256UC	600	38	3600	1	90	.37
					2	28	1.18
					3	12	2.73
					4	6	6.0

CCF-CB/CFSB SERIES

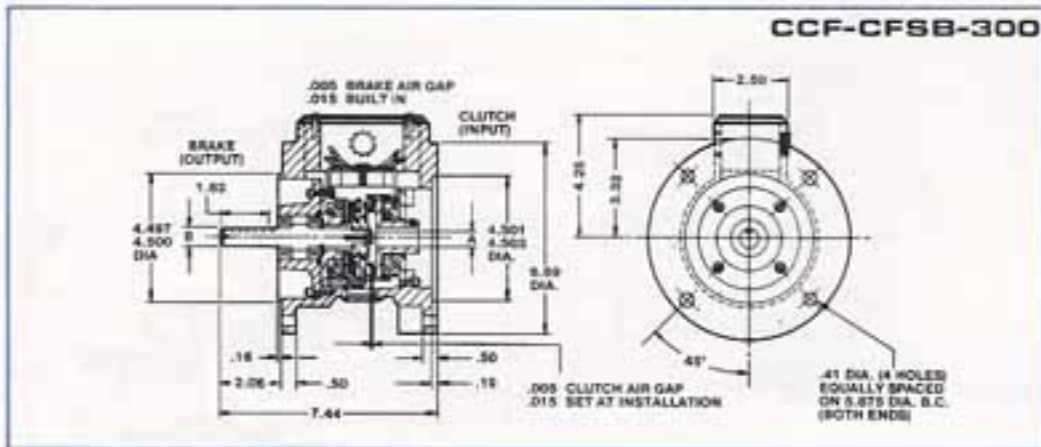
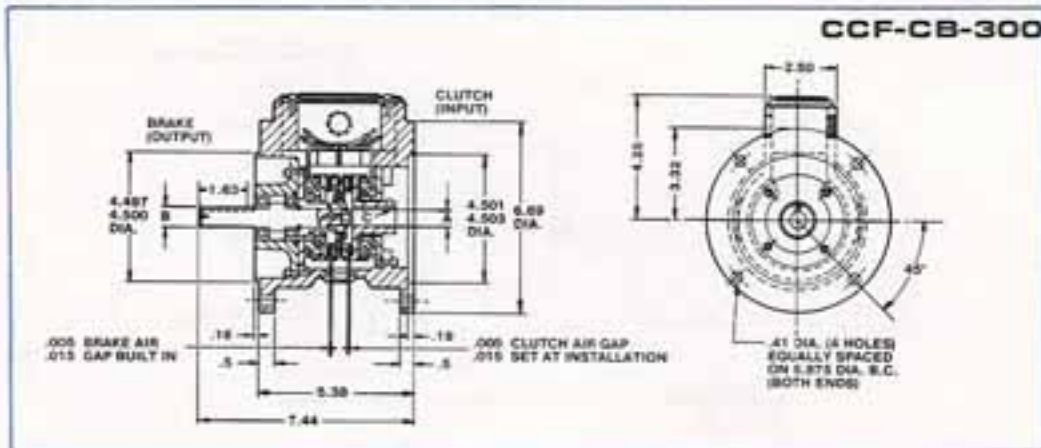

MODEL NO.	A	B	KEYWAY
CCF-CB-300	.625 .626	.624 .625	$\frac{3}{16} \times \frac{1}{32}$

MODEL NO.	A	B	C
CCF-CFSB-300	.625 .626	.624 .625	$\frac{3}{16} \times \frac{1}{32}$

CCF-CB-300/CFSB-300 NOTES:

Model CCF-CB or CCF-CFSB can be provided mounted to your motor as a tested-assembled package upon request.
 Static torque rating and dynamic torque rating will improve with cycling, which allows the meshing parts to wear-in, for maximum torque (and horsepower) transmittal.

CAUTION:

Do not hammer shaft or hub onto your motor or reducer, since this will result in ball bearing damage.
 Do not lubricate friction surfaces.

TECHNICAL DATA

MODEL NO.	MECHANICAL				WEIGHT (LBS.)	MAXIMUM RATED SPEED (RPM)	ELECTRICAL		
	NEMA MOTOR FRAME		RATED STATIC TORQUE (IN.-LBS.)				COIL NO.	RATED VOLTAGE (VDC)	CURRENT (AMPS)
	OLD	NEW	CLUTCH	BRAKE					
CCF-CB-300-10	56C	56C	65	65	8.5	3600	1	90	.12
CCF-CFSB-300-10	56C	56C	65	35			2	28	.39
							3	12	.89
							4	6	1.94

CCF-CB/CFSB SERIES

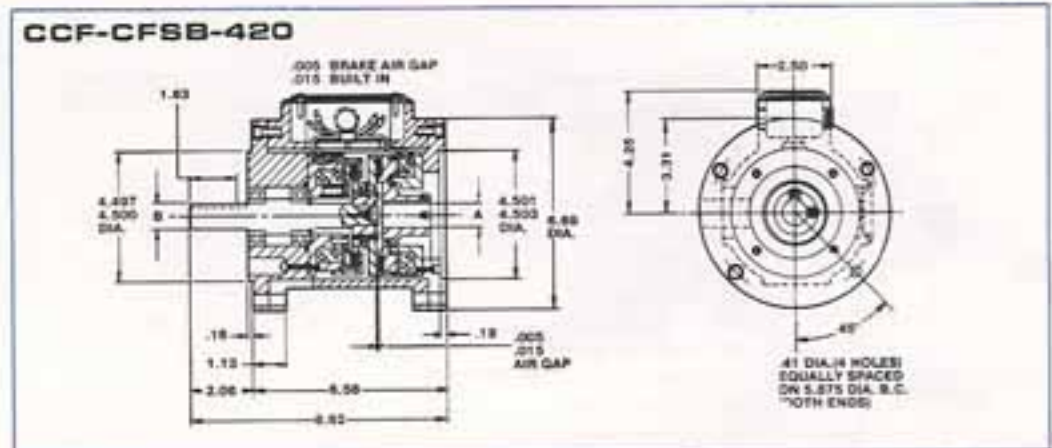
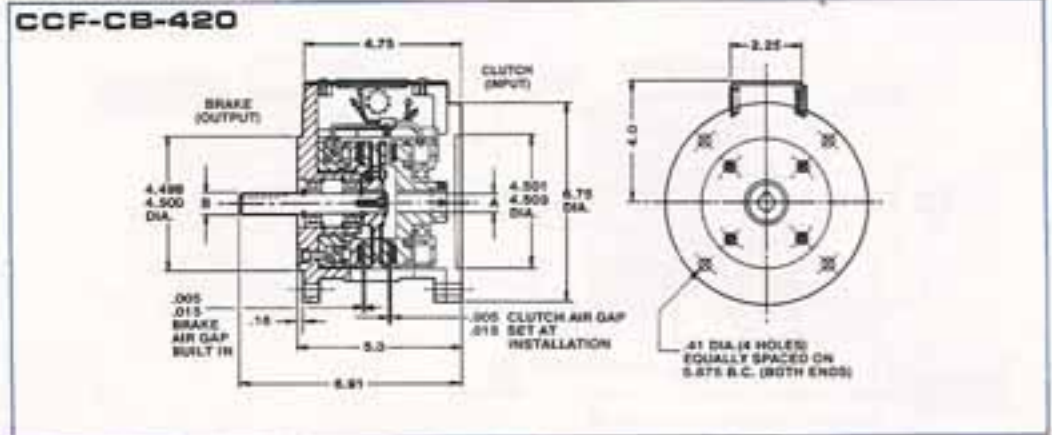

MODEL NO.	A	B	C
CCF-CB-420-10	.625 .626	.624 .625	$\frac{7}{16} \times \frac{7}{32}$
CCF-CB-420-14	.875 .876	.874 .875	$\frac{7}{16} \times \frac{7}{32}$

MODEL NO.	A	B	C
CCF-CFSB-420-10	.625 .626	.624 .625	$\frac{7}{16} \times \frac{7}{32}$
CCF-CFSB-420-14	.875 .876	.874 .875	$\frac{7}{16} \times \frac{7}{32}$

CCF-CB-420/CFSB-420 NOTES:

Model CCF-CB or CCF-CFSB can be provided mounted to your motor as a tested-assembled package upon request.

Static torque rating and dynamic torque rating will improve with cycling, which allows the meshing parts to wear-in, for maximum torque (and horsepower) transmittal.

CAUTION:

Do not hammer shaft or hub onto your motor or reducer, since this will result in ball bearing damage.

Do not lubricate friction surfaces.

TECHNICAL DATA

MODEL NO.	NEMA MOTOR FRAME	MECHANICAL		WEIGHT (LBS.)	MAXIMUM RATED SPEED (RPM)	ELECTRICAL			
		RATED STATIC TORQUE (IN.-LBS.)				COIL NO.	RATED VOLTAGE (VDC)	CURRENT (AMPS)	
		CLUTCH	BRAKE					CLUTCH	FSB
CCF-CB-420-10 CCF-CB-420-14	56C 143C, 145TC	240	240	18	3600	1	90	.14	
		240	240			2	28	.54	
						3	12	.93	
						4	6	1.82	
CCF-CFSB-420-10 CCF-CFSB-420-14	56C 143C, 145TC	240	100	18	3600	1	90	.14	.13
		240	100			2	28	.54	.55
						3	12	.93	1.12
						4	6	1.82	2.2

CCF-CB/CFSB SERIES

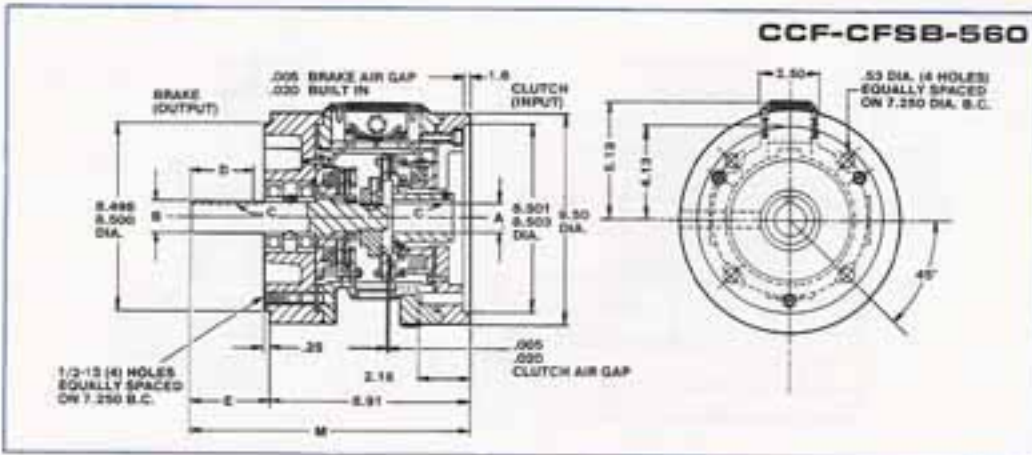
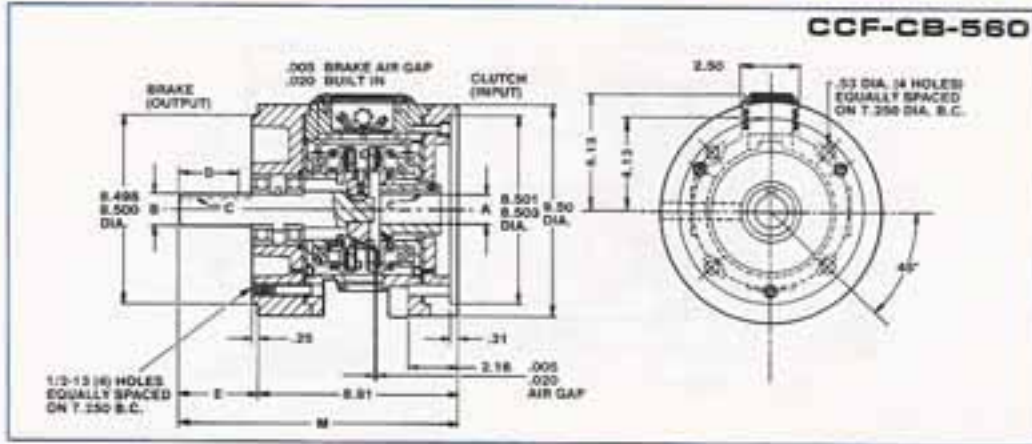

MODEL NO.	A	B	C	D	E	M
CCF-CB-560-18	1.125 1.126	1.125 1.125	1/4 x 1/8	2.0	2.75	11.66
CCF-CB-560-22	1.375 1.376	1.374 1.375	3/16 x 5/32	2.75	3.50	12.41
CCF-CFSB-560-18	1.125 1.126	1.124 1.125	1/4 x 1/8	2.0	2.75	11.66
CCF-CFSB-560-22	1.375 1.378	1.374 1.375	3/16 x 5/32	2.75	3.50	12.41

CCF-CB-560/CFSB-560 NOTES:

Model CCF-CB or CCF-CFSB can be provided mounted to your motor as a tested-assembled package upon request.

Static torque rating and dynamic torque rating will improve with cycling, which allows the meshing parts to wear-in, for maximum torque (and horsepower) transmittal.

CAUTION:

Do not hammer shaft or hub onto your motor or reducer, since this will result in ball bearing damage.

Do not lubricate friction surfaces.

TECHNICAL DATA

MODEL NO.	NEMA MOTOR FRAME	MECHANICAL		WEIGHT (LBS.)	MAXIMUM RATED SPEED (RPM)	ELECTRICAL			
		RATED STATIC TORQUE (IN.-LBS.)				COIL NO.	RATED VOLTAGE (VDC)	CURRENT (AMPS)	
		CLUTCH	BRAKE					CLUTCH	FSB
CCF-CB-560-18 CCF-CB-560-22	182TC, 184TC 213TC, 215TC	600 600	600 600	38	3600	1 2 3 4	90 28 12 6	.37 1.18 2.73 6.0	
CCF-CFSB-560-18 CCF-CFSB-560-22	182TC, 184TC 213TC, 215TC	600 600	200 200	38	3600	1 2 3 4	90 28 12 6	.37 1.18 2.73 6.0	.19 .69 1.4 2.20